

FOR CONTINUATION SEE LAYOUT NO.  
5223696-ATK-HGN-XX-DR-CH-000009

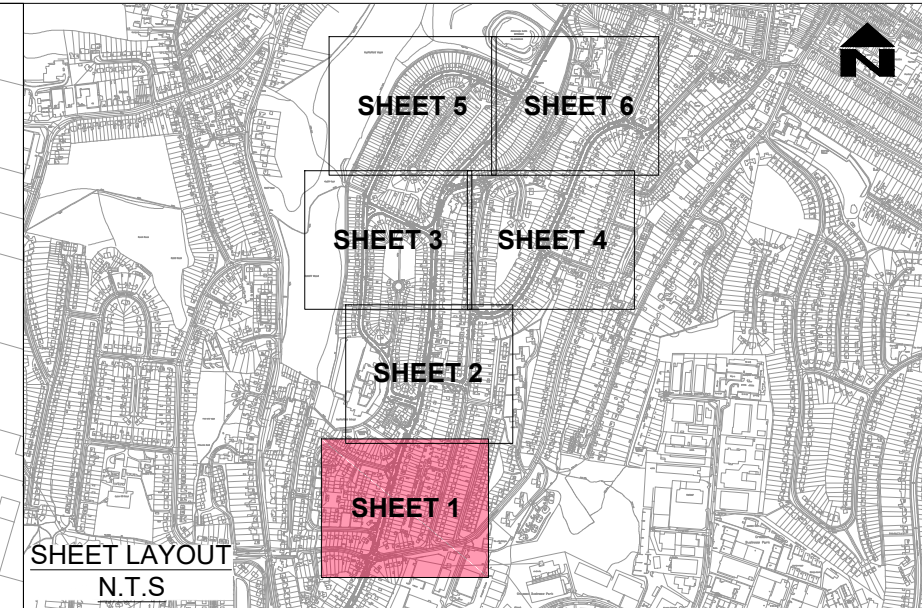

**NOTES:**

- FOR KEY AND NOTES, REFER TO DRAWING NO. 5223696-ATK-HGN-XX-DR-000025.

**SAFETY, HEALTH AND ENVIRONMENTAL INFORMATION**

In addition to the hazards/risks normally associated with the types of work detailed on this drawing, note the following significant residual risks (Reference shall also be made to the design hazard log).

**Construction**  
Live Traffic & Utilities.  
Presence of Tar, Presence of soil contamination, asbestos and breaking of concrete not known.

**Maintenance / Cleaning**  
None

**Use**  
None

**Decommissioning / Demolition**  
None

P01	RK	BJ	SD	10/04/24
-----	----	----	----	----------

For Tender Issue

Rev	Drawn / Des	Checked	Approved	Date
-----	-------------	---------	----------	------

Description

Drawing Status	Suitability
----------------	-------------

**FOR TENDER** **D2**

**AtkinsRéalis**  
Walton Street Office,  
Walton Street  
Aylesbury  
Buckinghamshire  
HP20 1UA GB  
www.atkinsrealis.com

Copyright © AtkinsRéalis Limited (2024)

Client

**Buckinghamshire Highways**  
Kevin Goad  
Service Director  
Highways & Technical Services

Project Title  
**5223696 BH23RS018 Castlefield High Wycombe Traffic – Calming Scheme**

Drawing Title  
**GENERAL ARRANGEMENT (SHEET 1 OF 6)**

Scale	1:500	Designed / Drawn	RK	Checked	BJ	Approved	SD	Authorised	JS
Original Size	A1	Date	09/04/24	Date	09/04/24	Date	10/04/24	Date	10/04/24
Drawing Number	5223696	Project	XX	Originator	ATK	Volume	HGN	Job No.	5223696
Location	XX	Type	DR	Role	CH	Number	000008	Revision	P01



THIS MAP IS REPRODUCED FROM ORDNANCE SURVEY MATERIAL WITH THE PERMISSION OF ORDNANCE SURVEY ON BEHALF OF THE CONTROLLER OF HIS MAJESTY'S STATIONERY OFFICE. © CROWN COPYRIGHT. UNAUTHORISED REPRODUCTION INFRINGES CROWN COPYRIGHT AND MAY LEAD TO PROSECUTION OR CIVIL PROCEEDINGS. License No. 10021029





FOR CONTINUATION SEE LAYOUT NO.  
5223696-ATK-HGN-XX-DR-CH-000010

FOR CONTINUATION SEE LAYOUT NO.  
5223696-ATK-HGN-XX-DR-CH-000011

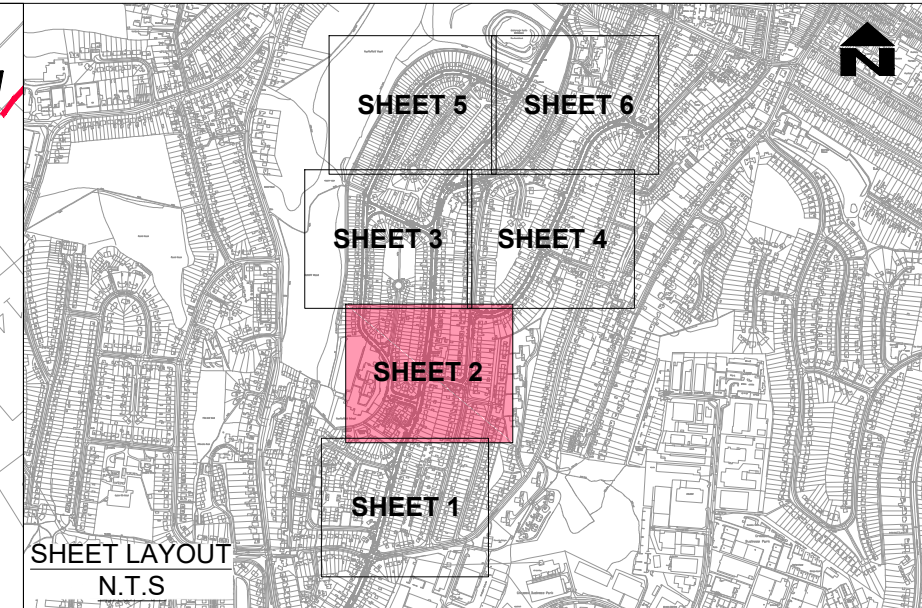

SHEET LAYOUT  
N.T.S

**NOTES:**

- FOR KEY AND NOTES, REFER TO DRAWING NO. 5223696-ATK-HGN-XX-DR-CH-000025.

**SAFETY, HEALTH AND ENVIRONMENTAL INFORMATION**

In addition to the hazards/risks normally associated with the types of work detailed on this drawing, note the following significant residual risks (Reference shall also be made to the design hazard log).

**Construction**  
Live Traffic & Utilities.  
Presence of Tar, Presence of soil contamination, asbestos and breaking of concrete not known.

**Maintenance / Cleaning**

None

**Use**

None

**Decommissioning / Demolition**

None

P01	RK	BJ	SD	10/04/24
-----	----	----	----	----------

For Tender Issue

Rev	Drawn / Des	Checked	Approved	Date
-----	-------------	---------	----------	------

Description

Drawing Status	Suitability
----------------	-------------

FOR TENDER

D2

**AtkinsRéalis**

Walton Street Office,  
Walton Street  
Aylesbury  
Buckinghamshire  
HP20 1UA GB  
www.atkinsrealis.com

Copyright © AtkinsRéalis Limited (2024)

Client



Kevin Goad  
Service Director  
Highways & Technical Services

Project Title  
5223696 BH23RS018 Castlefield  
High WycombeTraffic – Calming Scheme

Drawing Title  
GENERAL ARRANGEMENT  
(SHEET 2 OF 6)

Scale	Designed / Drawn	Checked	Approved	Authorised
1:500	RK	BJ	SD	JS
Original Size	Date	Date	Date	Date
A1	09/04/24	09/04/24	10/04/24	10/04/24
Drawing Number	Project	Volume	Job No.	Revision
5223696	5223696	5223696	5223696	5223696
XX	ATK	HGN	DR - CH - 000009	P01
Location	Type	Role	Number	

THIS MAP IS REPRODUCED FROM ORDNANCE SURVEY MATERIAL WITH THE PERMISSION OF ORDNANCE SURVEY ON BEHALF OF THE CONTROLLER OF HIS MAJESTY'S STATIONERY OFFICE. © CROWN COPYRIGHT. UNAUTHORISED REPRODUCTION INFRINGES CROWN COPYRIGHT AND MAY LEAD TO PROSECUTION OR CIVIL PROCEEDINGS. License No. 10021529

FOR CONTINUATION SEE LAYOUT NO.  
5223696-ATK-HGN-XX-DR-CH-000008



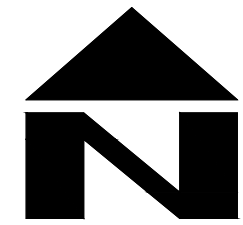

Rowliff Wood

Path

FOR CONTINUATION SEE LAYOUT NO. 5223696-ATK-HGN-XX-DR-CH-000012

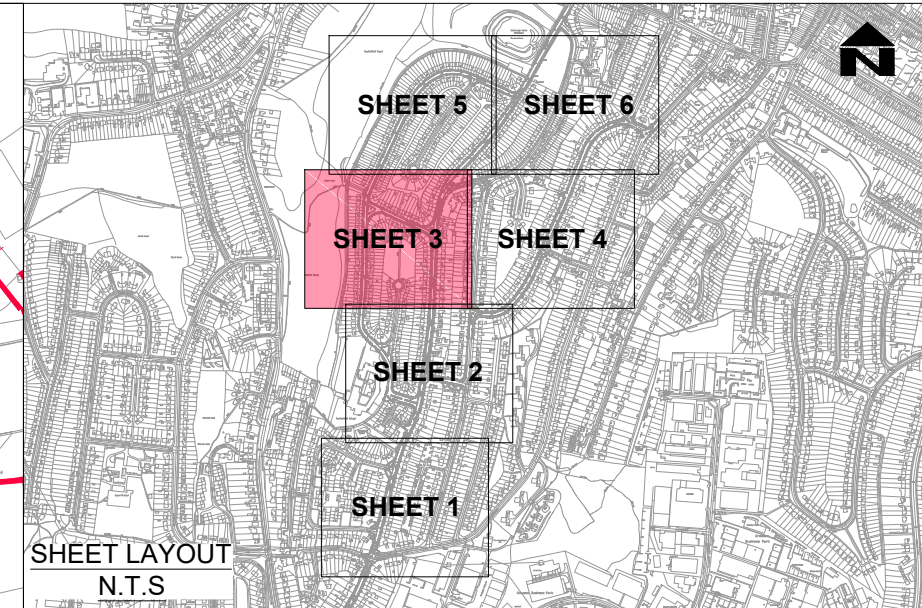

SHEET LAYOUT N.T.S.

NOTES:

- FOR KEY AND NOTES, REFER TO DRAWING NO. 5223696-ATK-HGN-XX-DR-CH-000025.

### SAFETY, HEALTH AND ENVIRONMENTAL INFORMATION

In addition to the hazards/risks normally associated with the types of work detailed on this drawing, note the following significant residual risks (Reference shall also be made to the design hazard log).

**Construction**  
 Live Traffic & Utilities.  
 Presence of Tar, Presence of soil contamination, asbestos and breaking of concrete not known.

**Maintenance / Cleaning**  
 None

**Use**  
 None

**Decommissioning / Demolition**  
 None

P01	RK	BJ	SD	10/04/24
-----	----	----	----	----------

For Tender Issue

Rev	Drawn / Des	Checked	Approved	Date
Description				

Drawing Status	Suitability
FOR REVIEW / COMMENT	S3

**AtkinsRéalis**  
 Walton Street Office,  
 Walton Street  
 Aylesbury  
 Buckinghamshire  
 HP20 1UA GB  
 www.atkinsrealis.com

Copyright © AtkinsRéalis Limited (2024)

Client  
 Kevin Goad  
 Service Director  
 Highways & Technical Services

Project Title  
 5223696 BH23RS018 Castlefield  
 High WycombeTraffic – Calming Scheme

Drawing Title  
 GENERAL ARRANGEMENT  
 (SHEET 3 OF 6)

Scale	Designed / Drawn	Checked	Approved	Authorised
1:500	RK	BJ	SD	---
Original Size	Date	Date	Date	Date
A1	09/04/24	09/04/24	10/04/24	---
Drawing Number	Project	Originator	Volume	Job No.
5223696	5223696	ATK	HGN	5223696
XX	XX	DR	CH	000010
Location	Type	Role	Number	Revision
				P01

THIS MAP IS REPRODUCED FROM ORDNANCE SURVEY MATERIAL WITH THE PERMISSION OF ORDNANCE SURVEY ON BEHALF OF THE CONTROLLER OF HIS MAJESTY'S STATIONERY OFFICE. © CROWN COPYRIGHT. UNAUTHORISED REPRODUCTION INFRINGES CROWN COPYRIGHT AND MAY LEAD TO PROSECUTION OR CIVIL PROCEEDINGS. License No. 10021529

FOR CONTINUATION SEE LAYOUT NO. 5223696-ATK-HGN-XX-DR-CH-000009





FOR CONTINUATION SEE LAYOUT NO. 5223696-ATK-HGN-XX-DR-CH-000013

FOR CONTINUATION SEE LAYOUT NO. 5223696-ATK-HGN-XX-DR-CH-000010

FOR CONTINUATION SEE LAYOUT NO. 5223696-ATK-HGN-XX-DR-CH-000009

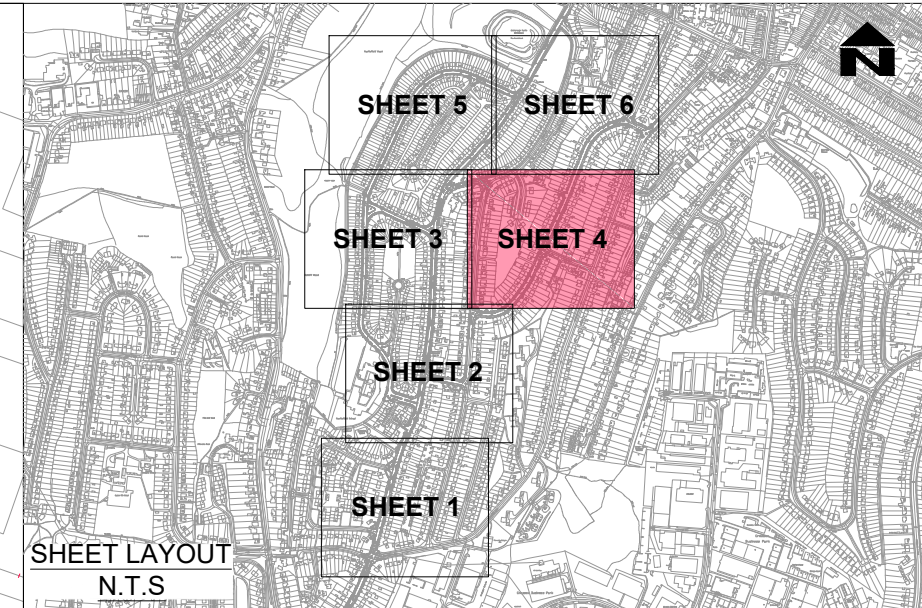

NOTES:  
1. FOR KEY AND NOTES, REFER TO DRAWING NO. 5223696-ATK-HGN-XX-DR-CH-000025.

**SAFETY, HEALTH AND ENVIRONMENTAL INFORMATION**

In addition to the hazards/risks normally associated with the types of work detailed on this drawing, note the following significant residual risks (Reference shall also be made to the design hazard log).

Construction  
Live Traffic & Utilities.  
Presence of Tar, Presence of soil contamination, asbestos and breaking of concrete not known

Maintenance / Cleaning  
None

Use  
None

Decommissioning / Demolition  
None

P01	RK	BJ	SD	10/04/24
-----	----	----	----	----------

For Tender Issue

Rev	Drawn / Des	Checked	Approved	Date
Description				

Drawing Status	Suitability
FOR TENDER	D2

**AtkinsRéalis**  
Walton Street Office,  
Walton Street  
Aylesbury  
Buckinghamshire  
HP20 1UA GB  
www.atkinsrealis.com

Copyright © AtkinsRéalis Limited (2024)

Client  
**Buckinghamshire Highways**  
Kevin Goad  
Service Director  
Highways & Technical Services

Project Title  
5223696 BH23RS018 Castlefield High Wycombe Traffic – Calming Scheme

Drawing Title  
GENERAL ARRANGEMENT (SHEET 4 OF 6)

Scale	Designed / Drawn	Checked	Approved	Authorised
1:500	RK	BJ	SD	JS
Original Size	Date	Date	Date	Date
A1	09/04/24	09/04/24	10/04/24	10/04/24
Drawing Number	Project	Volume	Job No.	Revision
5223696 XX	ATK - DR - CH - 000011	HGN - 000011	5223696	P01
Location	Type	Role	Number	

THIS MAP IS REPRODUCED FROM ORDNANCE SURVEY MATERIAL WITH THE PERMISSION OF ORDNANCE SURVEY ON BEHALF OF THE CONTROLLER OF HIS MAJESTY'S STATIONERY OFFICE. © CROWN COPYRIGHT. UNAUTHORISED REPRODUCTION INFRINGES CROWN COPYRIGHT AND MAY LEAD TO PROSECUTION OR CIVIL PROCEEDINGS. License No. 10021029



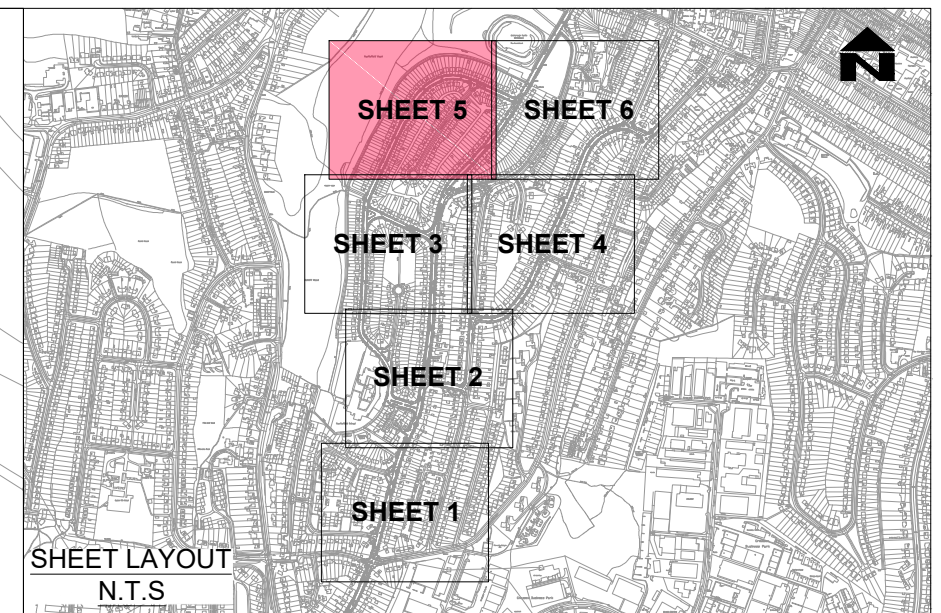
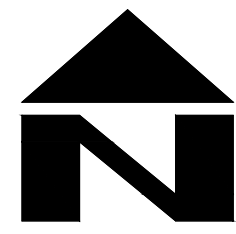

SHEET LAYOUT  
N.T.S.

NOTES:  
1. FOR KEY AND NOTES, REFER TO DRAWING NO. 5223696-ATK-HGN-XX-DR-CH-000025.

**SAFETY, HEALTH AND ENVIRONMENTAL INFORMATION**

In addition to the hazards/risks normally associated with the types of work detailed on this drawing, note the following significant residual risks (Reference shall also be made to the design hazard log).

Construction  
Live Traffic & Utilities.  
Presence of Tar, Presence of soil contamination, asbestos and breaking of concrete not known

Maintenance / Cleaning  
None

Use  
None

Decommissioning / Demolition  
None

P01	RK	BJ	SD	10/04/24
-----	----	----	----	----------

For Tender Issue

Rev	Drawn / Des	Checked	Approved	Date

Description

Drawing Status	Suitability
<b>FOR TENDER</b>	<b>D2</b>

**AtkinsRéalis**  
Walton Street Office,  
Walton Street  
Aylesbury  
Buckinghamshire  
HP20 1UA GB  
www.atkinsrealis.com

Copyright © AtkinsRéalis Limited (2024)

Client  
**Buckinghamshire Highways**  
Kevin Goad  
Service Director  
Highways & Technical Services

Project Title  
5223696 BH23RS018 Castlefield  
High Wycombe Traffic – Calming Scheme

Drawing Title  
**GENERAL ARRANGEMENT  
(SHEET 5 OF 6)**

Scale	Designed / Drawn	Checked	Approved	Authorised
1:500	RK	BJ	SD	JS
Original Size	Date	Date	Date	Date
A1	09/04/24	09/04/24	10/04/24	10/04/24

Drawing Number	Project	Originator	Volume	Job No.
5223696	XX	ATK	HGN	5223696
Location	Type	Role	Number	Revision
XX	DR	CH	000012	P01

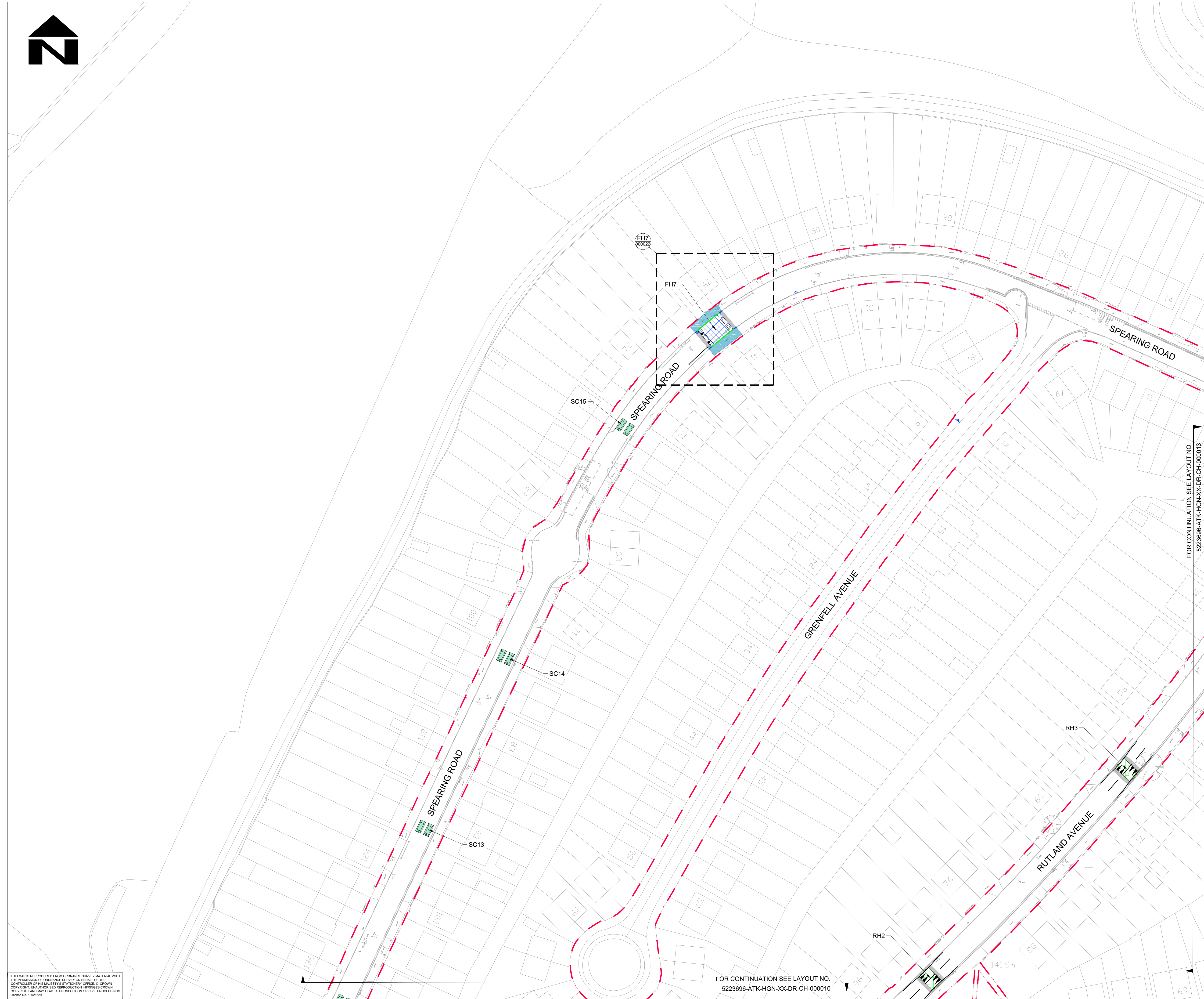

THIS MAP IS REPRODUCED FROM ORDINANCE SURVEY MATERIAL WITH THE PERMISSION OF ORDINANCE SURVEY ON BEHALF OF THE CONTROLLER OF HIS MAJESTY'S STATIONERY OFFICE. © CROWN COPYRIGHT. UNAUTHORISED REPRODUCTION INFRINGES CROWN COPYRIGHT AND MAY LEAD TO PROSECUTION OR CIVIL PROCEEDINGS. License No. 10021029

FOR CONTINUATION SEE LAYOUT NO. 5223696-ATK-HGN-XX-DR-CH-000010



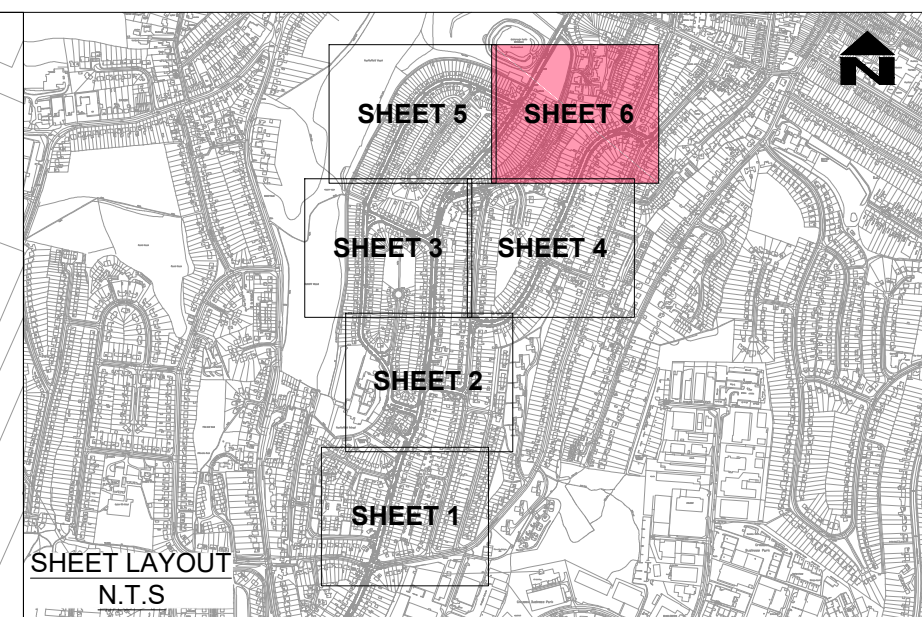
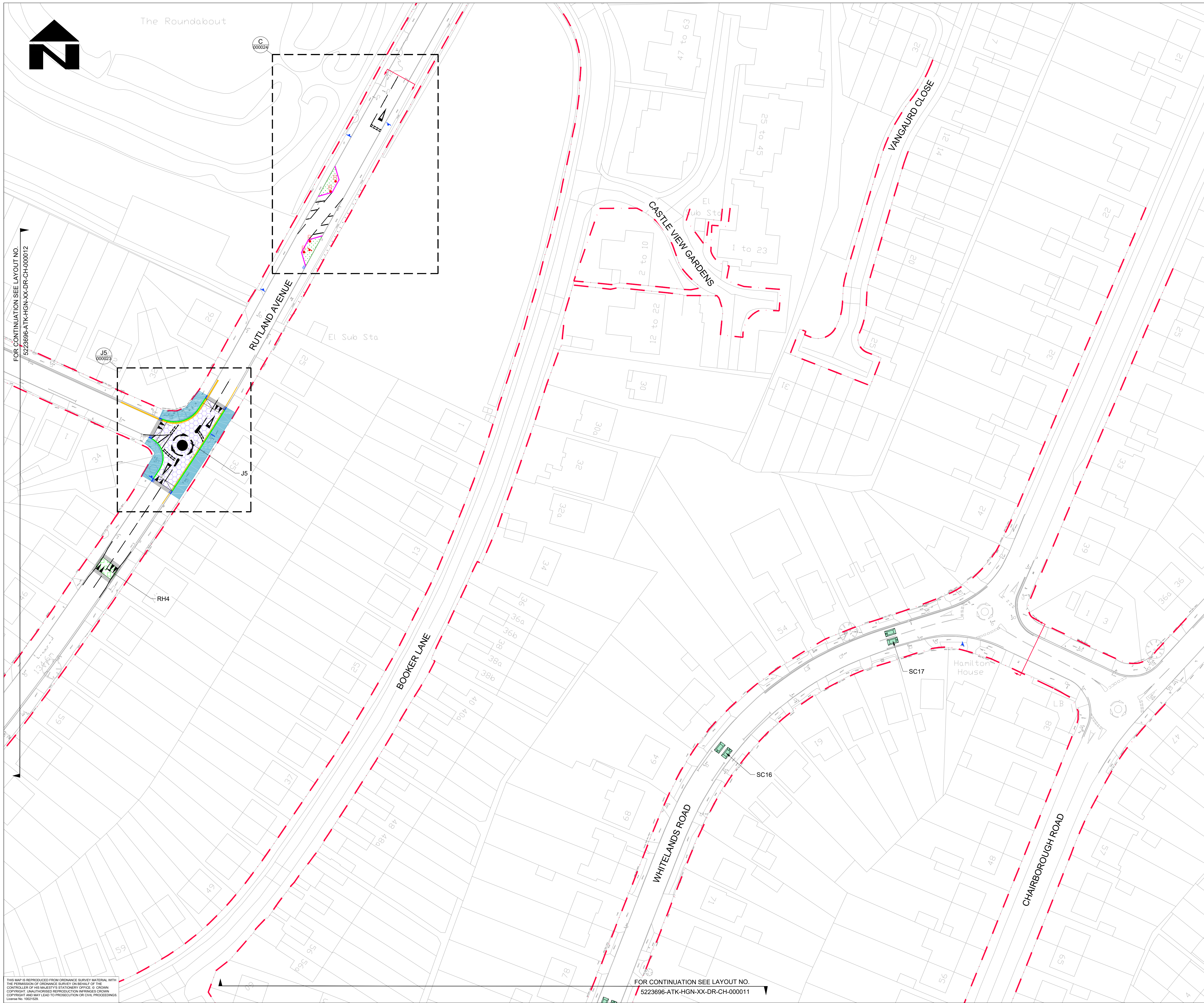

SHEET LAYOUT  
N.T.S.

NOTES:  
1. FOR KEY AND NOTES, REFER TO DRAWING NO. 5223696-ATK-HGN-XX-DR-CH-000025.

**SAFETY, HEALTH AND ENVIRONMENTAL INFORMATION**

In addition to the hazards/risks normally associated with the types of work detailed on this drawing, note the following significant residual risks (Reference shall also be made to the design hazard log).

**Construction**  
Live Traffic & Utilities.  
Presence of Tar, Presence of soil contamination, asbestos and breaking of concrete not known

**Maintenance / Cleaning**  
None

**Use**  
None

**Decommissioning / Demolition**  
None

P01	RK	BJ	SD	10/04/24
-----	----	----	----	----------

For Tender Issue

Rev	Drawn / Des	Checked	Approved	Date

Description

Drawing Status	Suitability
FOR TENDER	D2

**AtkinsRéalis**  
Walton Street Office,  
Walton Street  
Aylesbury  
Buckinghamshire  
HP20 1UA GB  
www.atkinsrealis.com

Copyright © AtkinsRéalis Limited (2024)

**Buckinghamshire Highways**  
Kevin Goad  
Service Director  
Highways & Technical Services

Project Title  
**5223696 BH23RS018 Castlefield High Wycombe Traffic – Calming Scheme**

Drawing Title  
**GENERAL ARRANGEMENT (SHEET 6 OF 6)**

Scale	Designed / Drawn	Checked	Approved	Authorised
1:500	RK	BJ	SD	JS
Original Size	Date	Date	Date	Date
A1	09/04/24	09/04/24	10/04/24	10/04/24
Drawing Number	Project	Volume	Job No.	Revision
5223696	XX	ATK - HGN - DR - CH - 000013	5223696	P01
Location	Type	Role	Number	

THIS MAP IS REPRODUCED FROM ORDNANCE SURVEY MATERIAL WITH THE PERMISSION OF ORDNANCE SURVEY ON BEHALF OF THE CONTROLLER OF HIS MAJESTY'S STATIONERY OFFICE. © CROWN COPYRIGHT. UNAUTHORISED REPRODUCTION INFRINGES CROWN COPYRIGHT AND MAY LEAD TO PROSECUTION OR CIVIL PROCEEDINGS. License No: 10021629

FOR CONTINUATION SEE LAYOUT NO. 5223696-ATK-HGN-XX-DR-CH-000011